

Model 41E

Precision Low Profile Load Cell



DESCRIPTION

Model 41E is a low profile “pancake” type load cells. These bonded foil, strain gage load cells are engineered to measure loads from 20 N to 200 kN. The tension/ compression Model 41E is designed with the threaded hole running completely through the center of the cell. Model 41E utilizes two stabilizing diaphragms, which are welded to the sensing member to reduce off-center and side-loading effects. It provides high

performance in non-linearity, hysteresis, and repeatability for such applications as tube mills, extruding and weighing. Each unit has a welded construction and is hermetically sealed for added durability. Model 41E load cells are available with optional 0 Vdc to 5 Vdc or 4 mA to 20 mA output.



FEATURES

- 0.1 % accuracy
- 20 N to 200 kN
- mV/V output (standard); 4 mA to 20 mA and 0 Vdc to 5 Vdc (optional) outputs
- Double diaphragm design
- Intrinsically safe available (2N option only)¹⁶
- CE approved¹⁷

Model 41E

PERFORMANCE SPECIFICATIONS

Characteristic	Measure
Load ranges ¹¹	20 N to 200 kN
Linearity, 20 N to 200 N	±0.2 % full scale
Linearity, 500 N to 200 kN	±0.1 % full scale
Hysteresis, 20 N to 200 N	±0.1 % full scale
Hysteresis, 500 N to 200 kN	±0.08 % full scale
Non-repeatability, 20 N to 200 N	±0.05 % full scale
Non-repeatability, 500 N to 200 kN	±0.03 % full scale
Output (tolerance), 20 N to 200 N	2 mV/V ±0.5 % full scale
Output (tolerance), 200 N to 200 kN	3 mV/V ±0.5 % full scale
Operation	Compression/tension
Resolution	Infinite
Standard calibration	Standard calibration for tension/compression load cells is in tension only

ENVIRONMENTAL SPECIFICATIONS

Characteristic	Measure
Temperature, operating	-55 °C to 120 °C [-67 °F to 248 °F]
Temperature, compensated	15 °C to 70 °C [60 °F to 158 °F]
Temperature effect, zero	0.004 % full scale/°C
Temperature effect, span	0.004 % reading/°C
Protection rating	IP65 ⁹

ELECTRICAL SPECIFICATIONS

Characteristic	Measure
Strain gage type	Bonded foil
Excitation (calibration)	10 Vdc
Insulation resistance	5000 mOhm @ 50 Vdc
Bridge resistance (tolerance)	350 ohm (nominal)
Shunt calibration data	Included
Electrical termination (std) 20 N to 200 kN	PTIH-10-6P bayonet plug (MIL-C-26482)
Electrical termination (std) 50 kN to 200 kN	MS3102E-14S-6P

MECHANICAL SPECIFICATIONS

Characteristic	Measure
Maximum allowable load	150 % FS ¹
Weight	See table
Material 20 N to 1.3 kN	17-4PH stainless steel
Material 1.5 kN to 200 kN	4340 painted
Deflection	76 micrometers
Natural frequency	See table

RANGE CODES

Range Code	Available ranges	Range Code	Available ranges
020NO	20 N	05KNO	5 kN
050NO	50 N	10KNO	10 kN
100NO	100 N	20KNO	20 kN
200NO	200 N	50KNO	50 kN
500NO	500 N	100KNO	100 kN
01KNO	1 kN	200KNO	200 kN
02KNO	2 kN		

WIRING CODES

Connector	Unamplified (Std.)
A	(+) excitation
B	(+) excitation
C	(-) excitation
D	(-) excitation
E	(-) output
F	(+) output

DEFLECTIONS AND RINGING FREQUENCIES

Capacity	Natural ringing frequency (Hz)	Weight kg [lb]	Capacity	Natural ringing frequency (Hz)	Weight kg [lb]
20 N	1000	0,36 [0.8]	5 kN	7000	0,68 [1.5]
50 N	1200	0,36 [0.8]	10 kN	10000	0,91 [2.0]
100 N	2000	0,36 [0.8]	20 kN	14000	0,91 [2.0]
200 N	2300	0,68 [1.5]	50 kN	4200	3,99 [8.8]
500 N	3500	0,68 [1.5]	100 kN	6400	4,99 [11.0]
1 kN	4300	0,68 [1.5]	200 kN	12000	4,99 [11.0]
2 kN	5100	0,68 [1.5]			

Precision Low Profile Load Cell

INTERNAL AMPLIFIERS

Amplifier specifications	Voltage output: Option 2b	Voltage output: Option 2c	Voltage output: Option 2t	Current three-wire: Option 2j	Current two-wire: Option 2k
Output signal	±5 V	0-5 V or ±5 V @ 45 mA	0-10 V or ±10 V @ 45 mA	4 mA to 20 mA	4 mA to 20 mA
Input power (voltage)	±15 V or 26 Vdc to 32 Vdc	11 Vdc to 28 Vdc	15 Vdc to 28 Vdc	22 Vdc to 32 Vdc	15 Vdc to 40 Vdc
Input power (current)	45 mA	40 mA	40 mA	65 mA	4 mA to 28 mA
Freq. resp (amp)	3000 Hz	3000 Hz	3000 Hz	2500 Hz	300 Hz
Power supply rej.	60 db	60 db	60 db	60 db	60 db
Operating temp.	-20 °F to 185 °F	-20 °F to 185 °F	-20 °F to 185 °F	0 °F to 185 °F	0 °F to 185 °F
Reverse voltage protection	Yes	Yes	Yes	Yes	Yes
Short cir. protection	Momentary	Momentary	Momentary	Yes	Yes
Wiring code: connector (std) ⁴	A (+) Supply B Output common C Supply return D (+) Output E Shunt Cal 1 F Shunt Cal 2	A (+) Supply B Output common** C Supply return** D (+) Output E Shunt Cal 1 F Shunt Cal 2	A (+) Supply B Output common** C Supply return** D (+) Output E Shunt Cal 1 F Shunt Cal 2	A (+) Supply B Output common** C Supply return** D (+) Output E Shunt Cal 1 F Shunt Cal 2	A (+) Supply B No connection C No connection D (+) Output E Case ground F No connection
Wiring code: cable ^{3,4,5}	R (+) Supply BI Output common G Supply return W (+) Output B Shunt Cal 1 Br Shunt Cal 2	R (+) Supply BI Output common* G Supply return* W (+) Output B Shunt Cal 1 Br Shunt Cal 2	R (+) Supply BI Output com* G Supply return* W (+) Output B Shunt Cal 1 Br Shunt Cal 2	R (+) Supply BI Output com* G Supply return* W (+) Output B Shunt Cal 1 Br Shunt Cal 2	R (+) Supply BI (+) Output W Case ground

* Black and green wires are internally connected.

** Pins B and C are internally connected.

Model 41E

OPTION CODES

	Many range/option combinations are available in our quick-ship and fast-track manufacture programs. Please see http://sensing.honeywell.com/TMsensor-ship for updated listings.
Load ranges	20, 50, 100, 200, 500, 1K, 2K, 5K, 10K, 20K, 50K, 100K, 200K N
Temperature compensation	15 °C to 70 °C 1j. -65 °C to 50 °C 1k. -20 °C to 85 °C
Internal amplifiers⁶	2b. ±5 Vdc 2c. 0 Vdc to 5 Vdc 2j. 4 mA to 20 mA (three-wire) output 2k. 4 mA to 20 mA (two-wire) ¹³ 2t. 0 Vdc to 10 Vdc output 2u. Unamplified, mV/V output
Internal amplifier enhancements	3a. Input/output isolation ¹² 3d. Remote buffered shunt calibration ⁸
Electrical termination	6-pin bayonet plug (MIL-C-26482) (20 N to 20 kN) MS3102E-14S-6P or equivalent (50 kN to 200 kN) 6e. Integral cable: Teflon 6f. Integral cable: PVC 6g. Integral cable: Neoprene ⁹ 6h. Integral cable: Silicone ⁹ 6i. Integral underwater cable ⁹ 6j. 1/2-14 conduit fitting with 5 ft of 4 conductor PVC cable 6q. Molded integral cable: Polyurethane ⁹
Shunt calibration	8a. Precision internal resistor ⁷
Bridge resistance⁹	12a. 1000 ohm (foil) (max. 200 °C) 12b. 5000 ohm (foil) (max. 120 °C)
Bridge type	31a. Dual bridge
Zero and span adjustment	14a. No access to pots 14c. Side access to pots
Electrical connector orientation	15b. Vertical electrical exit port orientation 15c. Radial electrical exit port orientation 15d. Connector on end of cable
Load direction	30a. Compression testing only, positive in compression 30b. Tension and compression testing only, positive in tension 30c. Compression testing only, negative in compression 30d. Tension and compression testing only, positive in compression
Shock and vibration	44a. Shock and vibration resistance
Interfaces	53e. Signature calibration ⁷ 53t. TEDS IEEE 1451.4 module ¹⁰

Precision Low Profile Load Cell

MOUNTING DIMENSIONS

Ranges	D mm [in]	H mm [in]	F#	G mm [in]	K mm [in]	T	A mm [in]	A* mm [in]	B mm [in]	B* mm [in]	C mm [in]	P mm [in]	R mm [in]
20 N	64 [2.51]	20 [0.79]	6	51 [2.00]	5 [0.2]	M6 x 1.0-6H	21 [0.83]	64 [2.52]	19 [0.75]	23 [0.91]	32 [1.26]	8 [0.31]	5 [0.20]
50 N	64 [2.51]	20 [0.79]	6	51 [2.00]	5 [0.2]	M6 x 1.0-6H	21 [0.83]	64 [2.52]	19 [0.75]	23 [0.91]	32 [1.26]	8 [0.31]	5 [0.20]
100 N	64 [2.51]	20 [0.79]	6	51 [2.00]	5 [0.2]	M6 x 1.0-6H	21 [0.83]	64 [2.52]	19 [0.75]	23 [0.91]	32 [1.26]	8 [0.31]	5 [0.20]
200 N	76 [2.99]	25 [0.98]	6	60 [2.36]	7 [0.28]	M10 x 1.0-6H	21 [0.83]	64 [2.52]	19 [0.75]	23 [0.91]	32 [1.26]	11 [0.43]	7 [0.28]
500 N	76 [2.99]	25 [0.98]	6	60 [2.36]	7 [0.28]	M10 x 1.0-6H	21 [0.83]	64 [2.52]	19 [0.75]	23 [0.91]	32 [1.26]	11 [0.43]	7 [0.28]
1 kN	76 [2.99]	25 [0.98]	6	60 [2.36]	7 [0.28]	M10 x 1.0-6H	21 [0.83]	64 [2.52]	19 [0.75]	23 [0.91]	32 [1.26]	11 [0.43]	7 [0.28]
2 kN	76 [2.99]	25 [0.98]	6	60 [2.36]	7 [0.28]	M10 x 1.0-6H	21 [0.83]	64 [2.52]	19 [0.75]	23 [0.91]	32 [1.26]	11 [0.43]	7 [0.28]
5 kN	76 [2.99]	25 [0.98]	6	60 [2.36]	7 [0.28]	M10 x 1.0-6H	21 [0.83]	64 [2.52]	19 [0.75]	23 [0.91]	32 [1.26]	11 [0.43]	7 [0.28]
10 kN	89 [3.50]	25 [0.98]	6	70 [2.76]	9 [0.35]	M12 x 1.5-6H	21 [0.83]	64 [2.52]	19 [0.75]	23 [0.91]	32 [1.26]	14 [0.55]	8 [0.31]
20 kN	89 [3.50]	25 [0.98]	6	70 [2.76]	9 [0.35]	M12 x 1.5-6H	21 [0.83]	64 [2.52]	19 [0.75]	23 [0.91]	32 [1.26]	14 [0.55]	8 [0.31]
50 kN	140 [5.51]	46 [1.81]	8	114 [4.49]	10 [0.39]	M24 x 1.5-6H	32 [1.26]	58 [2.28]	38 [1.5]	38 [1.5]	51 [2.08]	17 [0.67]	11 [0.43]
100 kN	152 [5.98]	46 [1.81]	8	124 [4.88]	14 [0.55]	M36 x 3.0-6H	32 [1.26]	58 [2.28]	38 [1.5]	38 [1.5]	51 [2.08]	NA	NA
200 kN	152 [5.98]	46 [1.81]	8	124 [4.88]	14 [0.55]	M36 x 3.0-6H	32 [1.26]	58 [2.28]	38 [1.5]	38 [1.5]	51 [2.08]	NA	NA

F clearance holes equally spaced on G diameter B.C.,
K diameter thru, c-bore P dia., X R deep

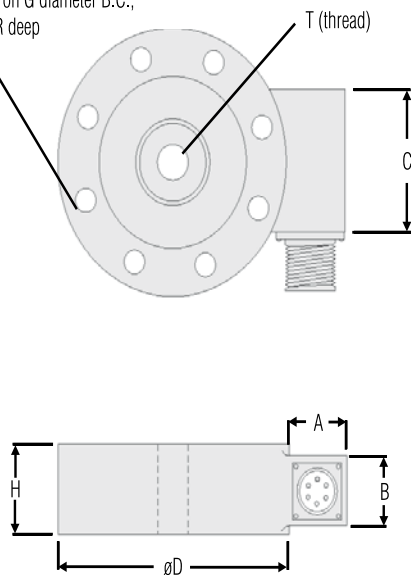

TYPICAL SYSTEM DIAGRAM

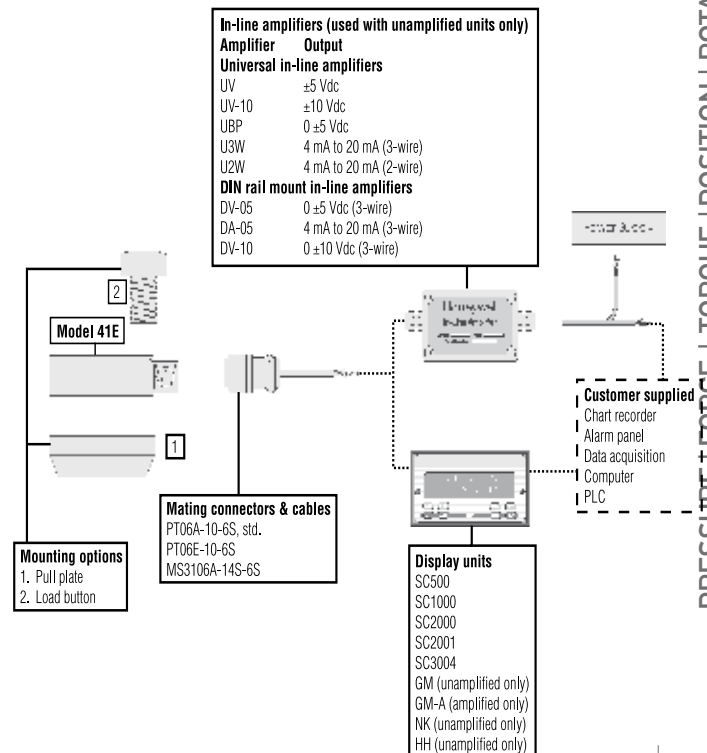

NOTES

1. Allowable maximum loads - maximum load to be applied without damage.²
2. Without damage - loading to this level will not cause excessive zero shift or performance degradation. The user must consider fatigue life for long term use and structural integrity. All structurally critical applications (overhead loading, etc.) should always be designed with safety redundant load paths.
3. Interconnecting shunt cal. 1 terminal with shunt cal. 2 terminal provides 50 % (unamplified units), 75 % (4 mA to 20 mA three-wire units) or 80 % (voltage amplified units) of full scale output for quick calibration. Shunt calibration comes standard with internal amplifier option 2a, 2b, 2c, 2t and 2j.
4. O=Orange; Y=Yellow; B=Blue; Bl=Black; R=Red; Br=Brown; W=White; G=Green. Color specifying cable and number or letter specifying connector.
5. No mating connector necessary for cable option.
6. Adding any internal amplifiers on 20 N to 100 N ranges will take typically six weeks for delivery.
7. Not available with amplified option.
8. Option 3d is not available with option 2k.
9. Availability varies with range, consult factory.
10. Consult factory for TEDS availability with amplified models.
11. This unit is calibrated to Metric (non-Imperial) units.
12. Input/output isolation only available with voltage output (2b or 2c).
13. 5000 ohm bridge required.

Warranty. Honeywell warrants goods of its manufacture as being free of defective materials and faulty workmanship. Honeywell's standard product warranty applies unless agreed to otherwise by Honeywell in writing; please refer to your order acknowledgement or consult your local sales office for specific warranty details. If warranted goods are returned to Honeywell during the period of coverage, Honeywell will repair or replace, at its option, without charge those items it finds defective. **The foregoing is buyer's sole remedy and is in lieu of all warranties, expressed or implied, including those of merchantability and fitness for a particular purpose. In no event shall Honeywell be liable for consequential, special, or indirect damages.**

While we provide application assistance personally, through our literature and the Honeywell web site, it is up to the customer to determine the suitability of the product in the application.

Specifications may change without notice. The information we supply is believed to be accurate and reliable as of this printing. However, we assume no responsibility for its use.

WARNING **PERSONAL INJURY**

- DO NOT USE these products as safety or emergency stop devices or in any other application where failure of the product could result in personal injury.

Failure to comply with these instructions could result in death or serious injury.

WARNING **MISUSE OF DOCUMENTATION**

- The information presented in this catalogue is for reference only. DO NOT USE this document as product installation information.
- Complete installation, operation and maintenance information is provided in the instructions supplied with each product.

Failure to comply with these instructions could result in death or serious injury.

ALTHEN reserves the right to vary the foregoing details without prior notice



ALTHEN GmbH Mess- und Sensortechnik

Frankfurter Strasse 150 - 152
65779 Kelkheim / Germany

phone: +49 (0)6195 70060
fax: +49 (0)6195 700666

sales@althensensors.com
www.althensensors.com