

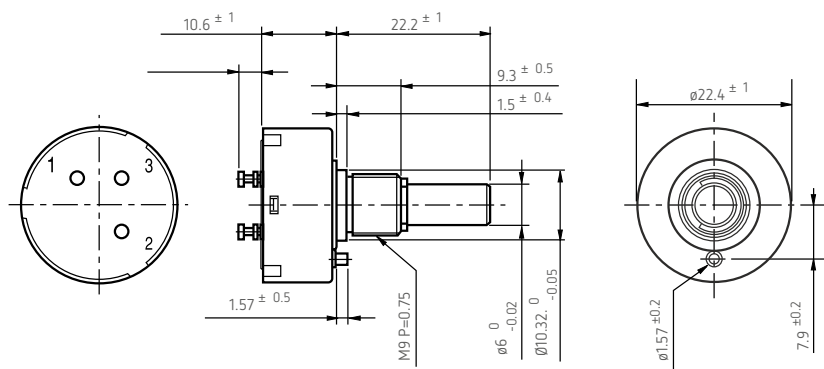

α FCP22R

Standard dimensions



Model FCP22R
(Plastic Housing)

- Note:**
- 1pc. Each inner teeth washer and hex nut are attached.
 - Please process the mounting hole on the panel to be mounted with this potentiometer by the diameter of 10.32mm^{+0.05}₀.

General Specifications

Standard Resistance

Values: 1k, 2k, 5k, 10 k (Ω)

Special Practical Resistance Values: 500, 20k, 50k, 100k (Ω)

Total Resistance Tolerance: Standard Class ±15% (L)
Precision Class ±10% (K)

Independent Linearity

Tolerance: Standard Class ±1.5%
Precision Class ±1.0%

Resolution: Essentially infinite

Output Smoothness: Within 0.1% against input voltage

Contact Resistance

Variation: Within 2% C.R.V.

Power Rating: 1.0.W

Electrical Travel: 340° ±5°

Mechanical Travel: 360° (Endless)

Insulation Resistance: Over 1,000MΩ at 500 V.D.C

Dielectric Strength: 1 minute at 500 V.A.C.

Starting Torque: Within 5mN·m (50gf·cm)

Resistance

Temperature Coefficient: ±400p.p.m./°C

Mass: Approx. 20g

Special Specifications Available

Extra taps (available up to 1 tap), special electrical travel, inch dimensional shaft dia. (ø6.35mm), bushing with inch dimensions, special machining on the shaft.