



kg **CBX**
Compression Load Cells - Low Profile



MOUNTING KITS



Manufactured according to OIML R60 standards
Capacity from 15000 kg to 50000 kg

FEATURES

- 17-4 PH STAINLESS STEEL
- COMBINED ERROR $\leq \pm 0.03\%$
- PROTECTION CLASS IP68

CAPACITY	kg				NET WEIGHT OF LOAD CELL (kg)	CODE
15000		•	•	•	1.4	CBX15000
30000		•	•	•	2.2	CBX30000
50000		•	•	•	3.8	CBX50000

ON REQUEST

CERTIFICATIONS

CERTIFICATIONS ON REQUEST

	Calibration report (ACCREDIA LAT traceability)
	ATEX II 1GD(zone 0-1-2-20-21-22)
	IECEx (zone 0-1-2-20-21-22)
	Complies with the Eurasian Custom Union regulations (Russia, Belarus, Kazakhstan)

OPTIONS ON REQUEST

DESCRIPTION

	Two redundant strain gauges Wheatstone bridges (350 Ω) with two output cables; for dual safety systems
--	--

ISO 9001:2008
ISO 14001:2004

Version 12.2020



TECHNICAL FEATURES

Material	17-4 PH stainless steel		
Nominal load (E max)	15000 - 30000 - 50000 kg		
Combined error	≤ ±0.035%		
Protection class	IP68		
Rated output	2 mV/V ± 0.1%	Input resistance	700 Ω ±5
Temperature effect on zero	0.005% °C	Output resistance	700 Ω ±5
Temperature effect on span	0.005% °C	Zero balance	± 1%
Compensated temperature range	-10 °C / + 50 °C	Insulation resistance	> 10000 MΩ
Operating temperature range	-20 °C / + 70 °C	Safe overload (% of full scale)	150%
Creep at nominal load in 30 minutes	0.03%	Ultimate overload (% of full scale)	300%
Max supply voltage without damage	15 V	Deflection at nominal load	0.4 mm

ELECTRICAL CONNECTIONS

Cable length	10 m
Cable diameter	5 mm
Cores	4 x 0.25 mm ² /6 x 0.14 mm ²

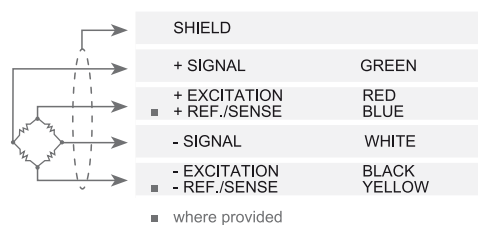

COMPLEMENTARY ACCESSORIES

	DESCRIPTION		CODE
	AISI 304 stainless steel threaded upper base for compression load cells.	M12x1.75 mm	BASESUPFIL
	AISI 304 stainless steel turned lower base for compression load cells.	Ø110x22 mm Ø140x23 mm	BINF100 BINF126
	Lower plate and turned upper base in AISI 304 stainless steel. Load cell capacity: 15000 kg.		BASESUP P10000
	Turned upper and lower bases in AISI 304 stainless steel. Load cell capacity: 15000 kg.		BASESUP BASEINF
	Lower plate and turned lower base in AISI 304 stainless steel. Load cell capacity: 15000 kg.		BASEINF PIASTRA200
	AISI 304 stainless steel adapter for mounting kits:		
	- V15000	Ø110x6 mm	ADAT100CBX15T
	- V30000	Ø126x9 mm	ADAT126CBX30T
	- V100000	Ø165x29 mm	ADAT165CBX50T



DIMENSIONS (mm)

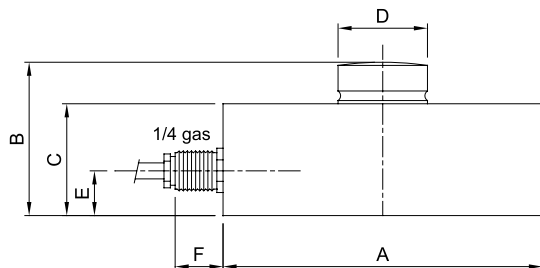

kg	15000	30000	50000
A	Ø82	Ø100	Ø126
B	44	48	54
C	32	35	40
D	Ø22	Ø28	Ø35
E	14	14	14
F	15	15	15



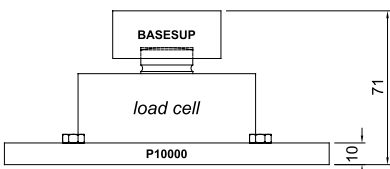

P10000

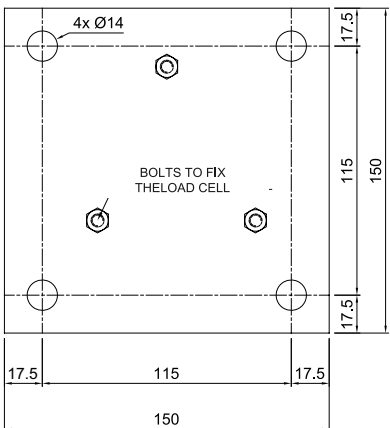

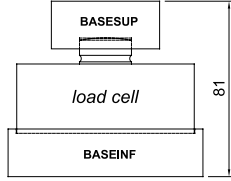

BASESUP

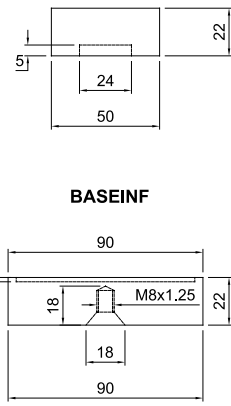

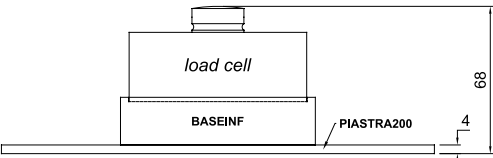

PIASTRA200

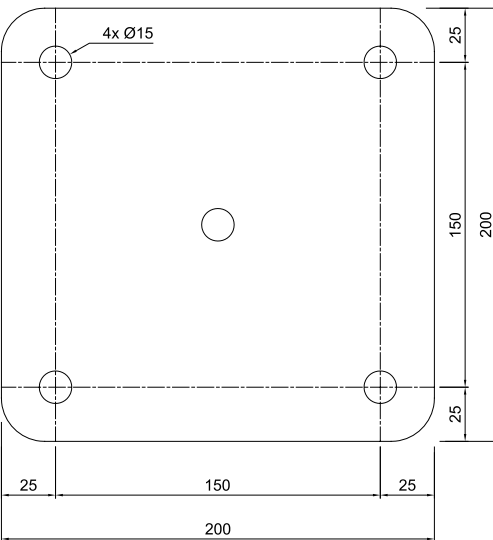

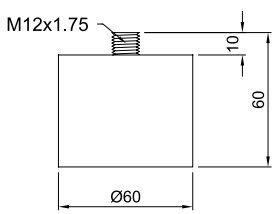

BASESUPFIL

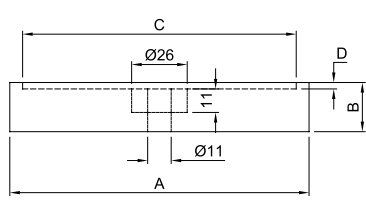

BINF

	A	B	C	D
BINF100	Ø110	22	Ø102	2
BINF126	Ø140	23	Ø128	3

The Company reserves the right to make changes to the technical data, drawings and images without notice.

The information provided herein is to the best of our knowledge true and accurate, it is provided for guidance only. All specifications are subject to change without prior notification.

Althen – Your expert partner in Sensors & Controls | althensensors.com

Althen stands for pioneering measurement and custom sensor solutions. In addition we offer services such as calibration, design & engineering, training and renting of measurement equipment.

Germany/Austria/Switzerland
info@althen.de

Benelux
sales@althen.nl

France
info@althensensors.fr

Sweden
info@althensensors.se

USA/Canada
info@althensensors.com

Other countries
info@althensensors.com