



kg

## ACBLR SERIES

Compression Miniature Load Cell (200kg ~ 3,000kg)

### FEATURES

- 17-4PH Stainless steel construction
- Fully welded seal (IP68)
- Compact size with low profile.



### SPECIFICATIONS

MODEL	ACBLR	ACBLTR
Rated capacity (R.C.)	200, 300, 500kg, 1, 2, 3ton	
Rated output (R.O.)	2.0mV/V(Approx.)	2.0mV/V $\pm$ 1%
Non-linearity	$\leq 0.2\%$ R.O.	
Hysteresis	$\leq 0.2\%$ R.O.	
Non-repeatability	$\leq 0.05\%$ R.O.	
Creep error	$\leq 0.05\%$ in 20min.	
Zero balance	$\leq 1\%$ R.O.	
Compensated temperature range	$-10 \sim 70^{\circ}\text{C}$	
Operating temperature range	$-20 \sim 80^{\circ}\text{C}$	
Temp. effect on rated output	$\leq 0.1\%$ LOAD/ $10^{\circ}\text{C}$	
Temp. effect on zero balance	$\leq 0.1\%$ R.O./ $10^{\circ}\text{C}$	
Terminal input resistance	$750 \pm 50$ Ohms	$820 \pm 70$ Ohms
Terminal output resistance	$700 \pm 5$ Ohms	
Insulation resistance (Min.)	2000 MOhms at 50V DC	
Excitation voltage	3~10V (Recommended), 12V (Max.)	
Electrical connection	$\varnothing 3\text{mm} \times 1.5\text{m}$ (28AWG x 4C Shielded)	
Protection class	meets IP 68	
Safe overload	150% R.C	
Ultimate overload	300% R.C	
Material	Stainless steel (17-4PH)	

\* Specifications are subject to change without notice



## OUTLINE CONSTRUCTION

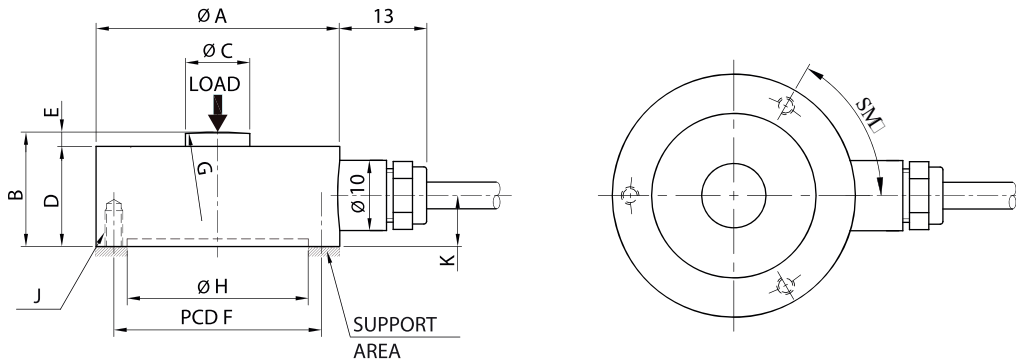

## DIMENSION-mm

Capacity	A	B	C	D	E	F	G	H	J	K	Weight(kg)
200kg ~ 2t (196.1N ~ 19.61kN)	Ø34	16	Ø9	14	2	Ø29	R50	Ø24	3-M3x0.5P Depth 5	7	0.09
3t (29.42kN)	Ø42	18	Ø10	15	3	Ø34	R50	Ø29	3-M4x0.7P Depth 6	7.5	0.14

## WIRING INFORMATION

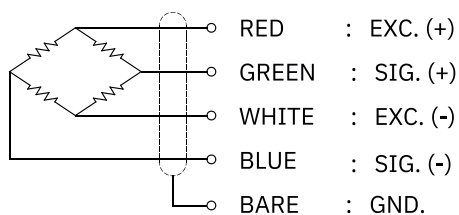

## ORDERING INFORMATION

### ACBLR - 500

#### MODEL

ACBLR  
ACBLTR

#### CAPACITY

200, 300, 500kg  
1, 2, 3ton