



kg

## ACMLR SERIES

Compression Miniature High Capacity Load Cell (5t~15t)

### FEATURES

- High capacity & Compact size
- 17-4PH Stainless steel



### SPECIFICATIONS

| MODEL                         | ACMLR                              |
|-------------------------------|------------------------------------|
| Rated capacity (R.C.)         | 5, 10, 15ton                       |
| Rated output (R.O.)           | 2mV/V (Nominal)                    |
| Non-linearity                 | ≤0.5% R.O.                         |
| Hysteresis                    | ≤0.5% R.O.                         |
| Non-repeatability             | ≤0.2% R.O.                         |
| Creep error                   | ≤0.1% in 20min.                    |
| Zero balance                  | ≤1% R.O.                           |
| Compensated temperature range | -10 ~ 70°C                         |
| Operating temperature range   | -20 ~ 80°C                         |
| Temp. effect on rated output  | ≤0.01% LOAD/°C                     |
| Temp. effect on zero balance  | ≤0.01% R.O./°C                     |
| Terminal input resistance     | 410 Ohms ± 30 Ohms                 |
| Terminal output resistance    | 350 Ohms ± 5 Ohms                  |
| Insulation resistance (Min.)  | 2000 MOhms at 50V DC               |
| Excitation voltage            | 3~12V(Recommended), 15V(Max.)      |
| Electrical connection         | Ø3mmx1.5m (28AWG x 4Core Shielded) |
| Protection class              | meets IP 65                        |
| Safe overload                 | 150% R.C                           |
| Ultimate overload             | 300% R.C                           |
| Material                      | Stainless steel (17-4PH)           |

\* Specifications are subject to change without notice



## OUTLINE CONSTRUCTION

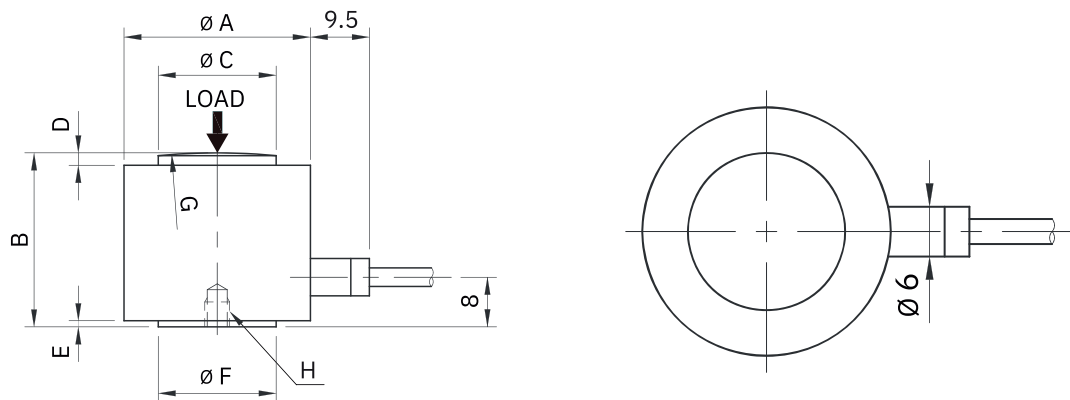

## DIMENSION-mm

| Capacity         | $\varnothing A$ | B  | $\varnothing C$ | D | E | $\varnothing F$ | G    | H                    | Weight (kg) |
|------------------|-----------------|----|-----------------|---|---|-----------------|------|----------------------|-------------|
| 5t<br>(49.04kN)  | 24              | 22 | 14              | 2 | 1 | 14              | R70  | M4 x 0.7P<br>Depth 3 | 0.10        |
| 10t<br>(98.07kN) | 30              | 28 | 19              | 2 | 1 | 19              | R100 | M4 x 0.7P<br>Depth 3 | 0.14        |
| 15t<br>(147.1kN) | 34              | 32 | 23              | 2 | 1 | 23              | R100 | M4 x 0.7P<br>Depth 4 | 0.20        |

## WIRING INFORMATION

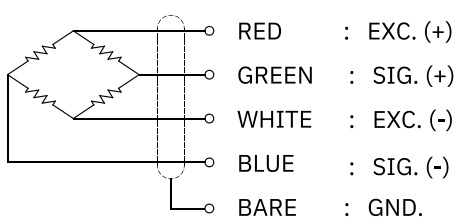

## ORDERING INFORMATION

**ACMLR - 10T**  
└─ **MODEL**      └─ **CAPACITY**  
ACMLR            5, 10, 15t