



N

ALW4-1
Hermetic Load Washer

Hermetic Load Washer is a stainless steel strain gauge based load washer with compensated temperature performance.

This type is fully laser welded and provides measurements up to 20,000 lbf with better than $\pm 0.5\%$ (full scale) non-linearity.



DIMENSIONS

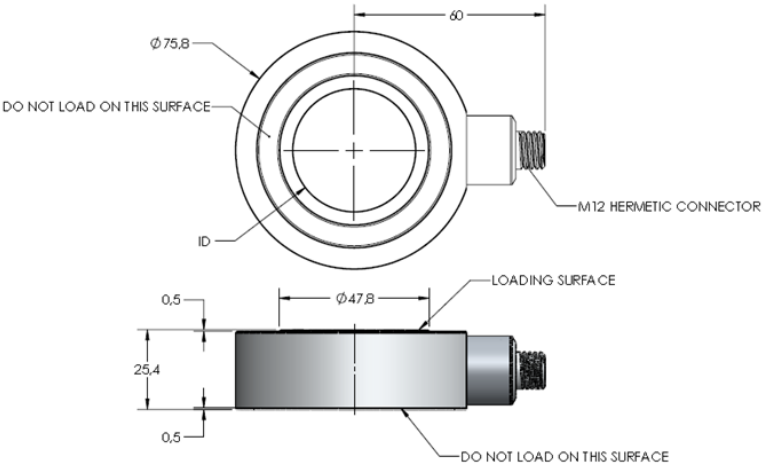

MODEL	ID	SCREW SIZE
ALW4-1	3.45mm [.136"]	1/8"
	5.11mm [.201"]	3/16"
	6.76mm [.266"]	1/4"
	8.43mm [.332"]	5/16"
	10.08mm [.397"]	3/8"
	11.91mm [.469"]	7/16"
	13.49mm [.531"]	1/2"
	15.09mm [.594"]	9/16"
	16.66mm [.656"]	5/8"
	19.84mm [.781"]	3/4"
	23.01mm [.906"]	7/8"
	26.19mm [1.031"]	1"
	32.54mm [1.281"]	1 1/4"
	38.89mm [1.531"]	1 1/2"



WIRING CODES

PIN	FUNCTION
1	Excitation +
2	Excitation -
3	Signal +
4	Signal -
5	No connection
6	No connection
7	No connection
8	No connection



NOTE: Voltage, current loop or digital output versions are also available on request.

SPECIFICATION

PARAMETER	RANGE
Capacity (lbf)	1K, 2K, 5K, 7.5K, 10K, 20K
Rated Output (RO) (mV/V)	2 nominal
Safe Overload (%)	150 of RO
Zero Balance (%)	±5 of RO
Excitation (VDC or VAC) (V)	5 (recommended), 10 max.
Bridge Resistance	700 Ω nom.
Non-Linearity (%)	±0.5 of RO
Hysteresis (%)	±0.5 of RO
Non-Repeatability (%)	±0.1 of RO
Temperature Shift Zero	±0.01 of RO/°C
Temperature Shift Span	±0.01 of load/°C
Compensated Temperature (°C)	-15 to +71
Operating Temperature (°C)	-20 to +80
Material	Stainless Steel
IP Rating	IP68
Calibration Test Excitation (V)	5, 10
Calibration (std)	5 pt. compression
Weight (g)	750 nominal
Deflection (mm)	0.05 [.002"]nominal
Connector	8-pin M12 male



■ ORDER DETAILS

To order a specific load washer required, compile and quote a unique part number from the example below.

			Screw Size (inch)	Capacity (lb)
ALW4	–	1	– X/X –	XXXXX
			1/8	1,000
			3/16	2,000
			1/4	5,000
			5/16	7,500
			3/8	10,000
			7/16	20,000
			1/2	
			9/16	
			5/8	
			3/4	
			7/8	
			1	
			1 ¼	
			1 ½	

Example: **ALW4-1-3/4-10,000**