



N ALF225

Description

- Measurement ranges 0 ... 50 kN and 0 ... 100 kN
- Compression
- Non-linearity 0.5 % RL
- Output signal 2.3 mV/V or rationalised 2.0 mV/V ± 0.5 %
- Supply voltage 10 VDC

The ultra slim design provides for ease of installation beneath heavy machinery mounts, hydraulic rams or interposed within series mechanical compression assemblies.

In the event of structural failure of the load cell the resulting vertical movement of the supported load including normal deflection will not exceed 2.5 mm.

Features

- Ultra low profile
- Fail-safe failure mode
- Hardened stainless steel
- IP67 sealing option
- Traceable calibration with certificate

Dimensions

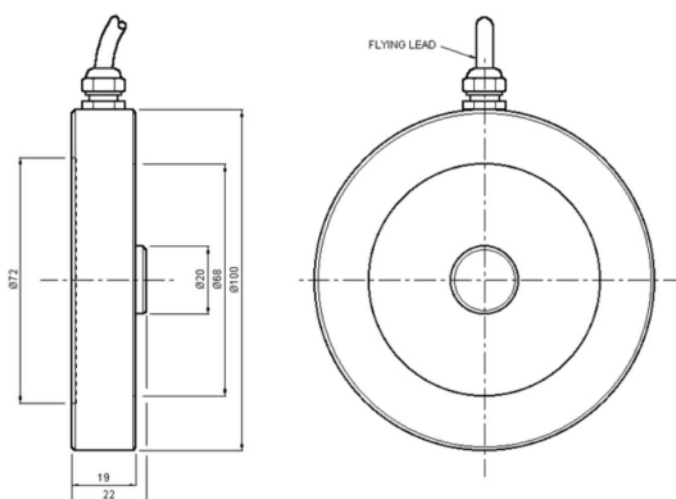

Dimensions in „mm“, approx. values

These drawings are for information only and not intended for engineering.
Please contact us for detailed drawings.



Specifications

Rated load:	50 kN / 100 kN
Calibration:	Compression
Non-linearity, terminal:	±0.5 % RL Hysteresis:
	±0.5 % RL
Creep, 20 min:	±0.05 % AL
Repeatability:	±0.02 % RL
Rated output, nominal:	2.3 mV/V
Rated output, rationalised:	2.0 mV/V ±0.5 % RL
Zero load output:	±4 % RL Temperature
effect on rated output:	±0.005 % AL/K
Temperature effect on zero load output:	±0.005 % RL/K
Compensated temperature range:	-10 ... +50 °C
Operating temperature range:	-10 ... +80 °C Supply
voltage, recommended:	10 V
Supply voltage, max.:	10 V
Bridge resistance:	350 Ω
Insulation resistance, minimum at 50 VDC:	500 MΩ
Overload, safe:	150 % RL Overload,
ultimate:	400 % RL
Dynamic load capacity:	70 % RL
Sealing:	IP65, optional IP67
Weight (excl. cable):	approx. 0.8 kg
Material:	Stainless steel

Rated load	Structural stiffness, nom.	Rated load	Structural stiffness, nom.
50 kN	2.1 x 10 ¹⁰ N/m	100 kN	4.2 x 10 ¹⁰ N/m

Notes:

1. RL = rated load
2. AL = applied load
3. Temperature coefficients apply over the compensated range.
4. The load must be applied directly through the central loading axis.
5. When this load cell is rationalised the resistors are housed in a capsule located in the load cell cable 100 mm from the free end. Capsule dimensions are Ø10 mm by 57 mm.

Electrical Connections

Wiring:	
Red	+ Supply voltage
Blue	- Supply voltage
Yellow	+ Output signal
Green	- Output signal
Orange	Screen

The load cell is fitted with 2 m of PVC insulated 4 core screened cable type 7-2-4C.

The screen is not connected to the load cell body.

Ordering Codes

ALF225CFR0H0	Compression, IP65	ALF225CFR0HN	Compression, IP65, rationalised
ALF225CFS0H0	Compression, IP67	ALF225CFS0HN	Compression, IP67, rationalised
Please add range in the required units.			

Due to continuous product development, ALTHEN and partners reserve the right to vary the foregoing details without prior notice.