



kg **CK**
Compression Load Cells - Low Profile

LAUMAS®

Capacity from 200 kg to 2500 kg



Manufactured according to OIML R60 standards

FEATURES

- 17-4PH Stainless Steel Construction
- Combined Error < +/- 0.5 %
- IP67 Protection Rating

CAPACITY

CAPACITY	kg	NET WEIGHT (kg)
	200	0.11
	500	0.08
	1000	0.17
	2500	0.17

CERTIFICATIONS

- EAC** Complies with the Eurasian Customs Union standards
- UKCA** Equivalent of the CE marking for the United Kingdom

CERTIFICATIONS ON REQUEST

✓	Linearity test
Ex	ATEX II 1GD (zone 0-1-2-20-21-22) (CE - UKCA)
IECEx	IECEx (zone 0-1-2-20-21-22)
EAC Ex	Complies with the Eurasian Customs Union standards for use in potentially explosive atmospheres



DIMENSIONS (mm)

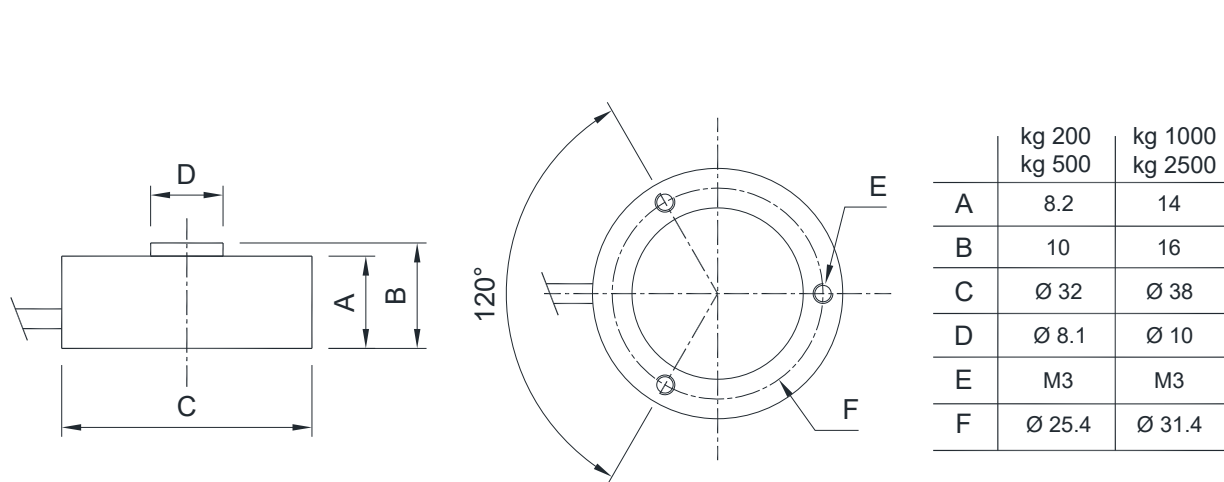

TECHNICAL FEATURES

Material	17-4 PH stainless steel		
Nominal load (E max)	200 - 500 - 1000 - 2500 kg		
Combined error	≤ ±0.5%		
Protection rating	IP67		

Rated output	1 mV/V ± 15%	Input resistance	400 Ω ±100
Temperature effect on zero	0.005% °C	Output resistance	350 Ω ±5
Temperature effect on span	0.005% °C	Zero balance	± 1%
Compensated temperature range	-10 °C / + 50 °C	Insulation resistance	> 5000 MΩ
Operating temperature range	-20 °C / + 70 °C	Safe overload (% of full scale)	120%
Creep at nominal load in 30 minutes	0.3%	Ultimate overload (% of full scale)	200%
Max supply voltage without damage	15 V	Deflection at nominal load	0.3 mm

ELECTRICAL CONNECTIONS

Cable length	5 m
Cable diameter	3 mm
Cores	4 x 0.25 mm ²

