



α MRI40A

Features

- 40 mm case diameter
- Magnetic incremental encoder
- 2-4-8-16-25-32-40-50-64-80-100-125, 128- 160-200-250-256-400-500-512 ppr.
- IP 54 protection



Technical Specifications

Type of Measurement	Magnetic incremental contactless	Max. Speed	3.500 rpm
Resolution	2 ... 512 ppr.	Shaft diameter	Ø4-6-8 mm
Output Channels	A,B,Z or A \bar{A} , B \bar{B} , Z \bar{Z} .	Shaft material	Stainless Steel
Output Type	Push-pull, TTL Linedriver or HTL Linedriver	Case diameter	Ø40 mm
Supply Voltage	8-24 VDC (Standard) or 5 VDC (Optional)	Case material	Aluminium Steel
Power Consumption (without load)	< 40 mA (24 VDC)	IP Degree	IP 54
Electrical Connections	2.5m Cable (Standard)	Operating temperature	-20°C ... +80°C
Max. Permissible Shaft Loading Radial	100 N	Storage temperature	-30°C ... +90°C
Axial	60 N		

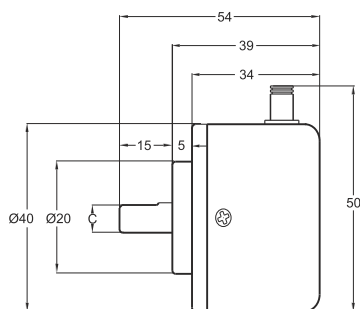

Shaft Type / Radial

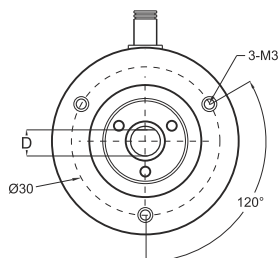

MRI 40	R (shaft)	
	C	D
	Ø4mm	3.60mm
	Ø6mm	5.50mm
	Ø8mm	7.30mm

Push-Pull / TTL Linedriver Cable Output

- +V : Brown
- 0V : White
- GND : Shield
- Ch A : Yellow
- Ch B : Green
- Ch Z : Gray
- Ch A inv. : Blue
- Ch B inv. : Red
- Ch Z inv. : Pink

HTL Linedriver Cable Output

- +V : Brown
- 0V : White
- GND : Shield
- Ch A : Yellow
- Ch B : Green
- Ch Z : Gray
- Ch A inv. : Blue
- Ch B inv. : Red
- Ch Z inv. : Pink

Model	Case Diameter	Case Type	Shaft Diameter	Output	Resolution	Output Channels	Supply Voltage	Connector / Cable	Cable Output
(example) MRI	40	A	R6	HLD	500	Z	V2	2M5	R
MRI	40mm	A : Clamping flange AW : Water proof	R4 : 4mm R6 : 6mm R8 : 8mm	LTP : Push-Pull TTL : TTL Linedriver HLD : High Linedriver	2 ... 512 ppr.	Z : A, B, Z B : A, B	V1 : 5V DC V2 : 8-24V DC	2M5 : 2,5 meter cable 5M : 5 meter cable 8M : 8 meter cable 10M : 10 meter cable C12 : 12 pin connector	R : Radial A : Axial