



mm SLPS

FEATURES

- Measuring range 10 - 100 mm
- For tight area applications
- <0.01 mm repeatability
- Infinite resolution
- 2 kOhm: 10 - 50 mm
- 5 kOhm: 75 - 100 mm

TECHNICAL SPECIFICATIONS

Measurement stroke	10 - 100 mm
Linearity	± 0.2 (75-100 mm), ± 0.5 (<75 mm)
Repeatability	< 0.01 mm
Resolution	Infinite
Resistance	2 kOhm : 10 - 50 mm 5 kOhm : 75 - 100 mm
Resistance tolerance	± 20
Load resistance	100 kOhm min.
Recommended cursor current	< 1 μ A
Permissible applied voltage	100 VDC max.

MECHANICAL SPECIFICATIONS

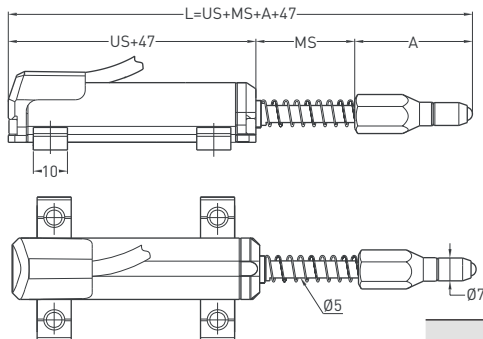

SLPS (mm)	10	25	50	75	100
US (Usefull Stroke)	10	25	50	75	100
MS (Mechanical Stroke)	13	28	53	78	103
L (Total Length)	105	135	192	242	292

A	
SLPS	35
SLPS 25	35
SLPS 50	42
SLPS 75	42
SLPS 100	42



SLPS
Cable type



SLPS
Connector type

Electrical connections	Connector or 1 m cable output
Displacement speed	< 5 m/s
Mechanical life	> 100 million movement
Case dimensions	Ø18 mm
Case material	Anodized aluminium
Rod material	Stainless steel
Rod diameter	Ø5 mm
Mechanical fixing	Variable brackets
Protection level	IP 65 - EN 60529
Operating temperature	-20°C ... +80°C
Storage temperature	-30°C ... +90°C

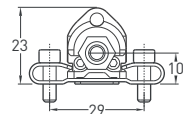
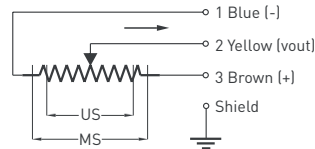
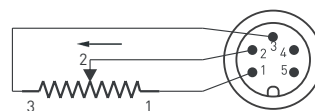
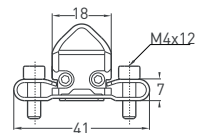
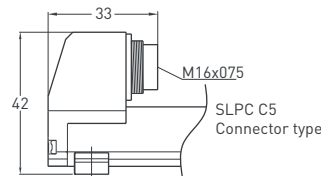

ORDERING PROCEDURE

Model	Measurement stroke (mm)	Linearity (%)	Resistance (kOhm)	Connector / Cable
SLPS (example)	75	D	5K	C5
SLPS	10 - 100 mm	A : ± 0.5 (<75 mm) D : ± 0.2 (75 - 100 mm)	2K : 2 kOhm (<75 mm) 5K : 5 kOhm (75-100 mm)	1M : 1 meter cable 1M5 : 1,5 meter cable 2M : 2 meter cable C5 : Connector